

HD Series

The design of the HD Model knob is unique. The taller profile of this knob, along with ergonomically designed finger surface, distinguishes it as a knob that has been specified on 1000's of high-end front panel applications.

Partial top and full-length side saw cut indicator line.
Two 6-32 set screws.



HD-90 - Black



HD-75 - Clear



HD-63 - Black



HD-50 - Clear

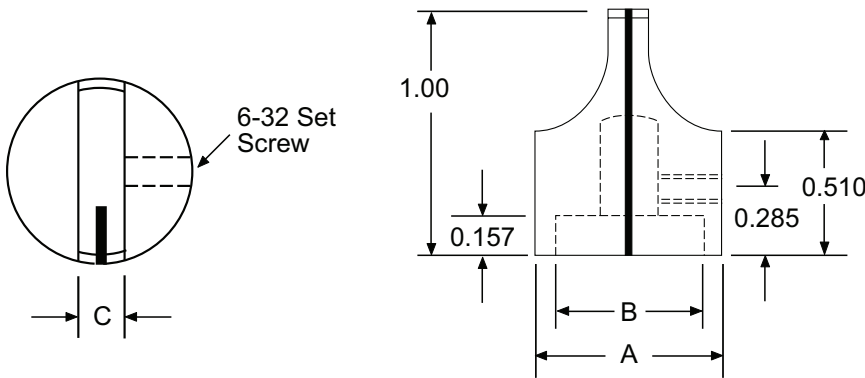

HD Series - How to Order

Part Number Example: **HD-50-1-5**

HD	50	1	5
	Dimensions (inches)	Color	Shaft
	A B C	1 = Clear Gloss	5 = .250"
	50 = .500 .375 .125	2 = Black Gloss	6 = .125"
	63 = .625 .500	3 = Clear Matte	6mm = 6mm
	75 = .750 .590 .187	4 = Black Matte	
	90 = .925 .708 .250		